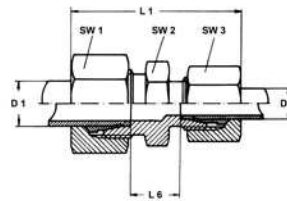

**Gerade  
Reduzierschraubungen**
**Reducing unions**
**Racores de reducción rectos**

**GR-..S**

Type	Mat.-Nr.	Serie	PN	D1	D2	L1	L6	SW1	SW2	SW3	g/Stk
GR-08/06S	708.1024.140.30	S	630	8	6	47.0	18.0	19	17	17	75
GR-10/06S	708.1024.175.30	S	630	10	6	48.0	17.5	22	19	17	95
GR-10/08S	708.1024.190.30	S	630	10	8	48.0	17.5	22	19	19	100
GR-12/06S	708.1024.215.30	S	630	12	6	50.0	19.5	24	22	17	105
GR-12/08S	708.1024.225.30	S	630	12	8	50.0	19.5	24	22	19	115
GR-12/10S	708.1024.240.30	S	630	12	10	51.0	19.0	24	22	22	125
GR-14/06S	708.1024.296.30	S	630	14	6	52.0	20.0	27	24	17	125
GR-14/08S	708.1024.300.30	S	630	14	8	52.0	20.0	27	24	19	140
GR-14/10S	708.1024.320.30	S	630	14	10	54.0	20.5	27	24	22	125
GR-14/12S	708.1024.340.30	S	630	14	12	54.0	20.5	27	24	24	165
GR-16/06S	708.1024.466.30	S	400	16	6	54.0	20.0	27	27	17	170
GR-16/08S	708.1024.468.30	S	400	16	8	54.0	20.0	30	27	19	180
GR-16/10S	708.1024.470.30	S	400	16	10	54.5	20.0	30	27	22	185
GR-16/12S	708.1024.480.30	S	400	16	12	54.0	20.0	30	27	24	190
GR-16/14S	708.1024.500.30	S	400	16	14	57.0	21.5	30	27	27	215
GR-20/06S	708.1024.650.30	S	400	20	6	57.0	21.0	36	32	17	230
GR-20/08S	708.1024.655.30	S	400	20	8	59.0	21.0	36	32	19	250
GR-20/10S	708.1024.660.30	S	400	20	10	59.5	22.0	36	32	22	270
GR-20/12S	708.1024.665.30	S	400	20	12	59.5	22.0	36	32	24	280
GR-20/14S	708.1024.675.30	S	400	20	14	62.5	23.5	36	32	27	300
GR-20/16S	708.1024.685.30	S	400	20	16	62.5	23.0	36	32	30	315
GR-25/06S	708.1024.788.30	S	400	25	6	62.5	24.0	46	41	17	450
GR-25/08S	708.1024.787.30	S	400	25	8	62.5	24.0	46	41	19	465
GR-25/10S	708.1024.789.30	S	400	25	10	64.0	24.0	46	41	22	480
GR-25/12S	708.1024.791.30	S	400	25	12	66.0	24.0	46	41	24	500
GR-25/14S	708.1024.790.30	S	400	25	14	67.5	24.0	46	41	27	545
GR-25/16S	708.1024.800.30	S	400	25	16	64.5	25.5	46	41	30	552
GR-25/20S	708.1024.820.30	S	400	25	20	71.0	25.5	46	41	36	564
GR-30/10S	708.1024.939.30	S	400	30	10	68.5	26.0	50	46	22	548
GR-30/12S	708.1024.940.30	S	400	30	12	68.5	26.0	50	46	24	555
GR-30/14S	708.1024.941.30	S	400	30	14	70.0	26.0	50	46	27	580
GR-30/16S	708.1024.942.30	S	400	30	16	74.0	26.0	50	46	30	632
GR-30/20S	708.1024.943.30	S	400	30	20	74.0	26.0	50	46	36	778
GR-30/25S	708.1024.945.30	S	400	30	25	77.0	26.5	50	46	46	802
GR-38/10S	708.1024.967.30	S	315	38	10	72.5	26.0	60	58	22	870
GR-38/12S	708.1024.968.30	S	315	38	12	72.5	26.0	60	55	24	885
GR-38/14S	708.1024.969.30	S	315	38	14	74.0	26.0	60	55	27	910
GR-38/16S	708.1024.970.30	S	315	38	16	74.5	26.0	60	55	30	925
GR-38/20S	708.1024.971.30	S	315	38	20	83.0	28.0	60	55	36	975
GR-38/25S	708.1024.972.30	S	315	38	25	87.0	29.0	60	55	46	1090
GR-38/30S	708.1024.975.30	S	315	38	30	87.0	29.5	60	55	50	869

Baumaße sind Ungefährmaße bei angezogener Überwurfmutter.

Sizes are approximate dimensions at tightened nut.

Las medidas son aproximadas con la tuerca de unión apretada.

